

NASclean®

High-Speed Vent Filters

Using the NASclean® pleated all metal gas filter as a high-speed vent element allows for a large reduction in venting time and the suppression of raised particles when returning to normal pressure



Features

- Reduced Loadlock Vent Time
- Improved Particle Control
(Diffuse gas inlet reduces turbulence)
- Highly Reliable (even at high inlet pressure)
- Compact and Cost Effective

NASclean is trademark of Nippon Seisen.
® Indicate a Nippon Seisen trademark registered in the USA.

Standard Specification

Particle Retention	0.0025µm
Maximum Supply Pressure	0.5MPa
Maximum Operating Temperature	460°C

Material	Media	316L Stainless Steel
	Joint	316L Stainless Steel

Dimensions

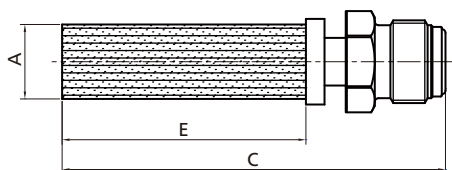

Unit:mm

Model	A	C	E
HSV-TF3G 1/4VCR L96	(φ15)	96	53
HSV-TF2G 1/2VCR L78	(φ20)	78	40
HSV-TF2G 1/2VCR L103	(φ20)	103	65
HSV-TF2G 1/2VCR L162	(φ20)	162	123
HSV-TFLG 1/2VCR L99	(φ30)	99	49
HSV-TFLG 1/2VCR L206	(φ30)	206	156

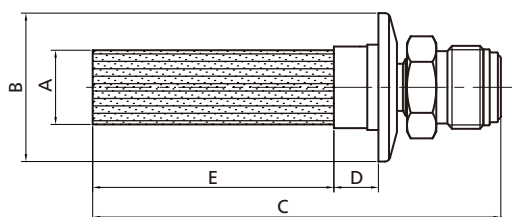

Unit:mm

Model	A	B	C	D	E
HSV-TF3G 1/4VCR-NW25 L96	(φ15)	φ40	96	10	53
HSV-TF2G 1/2VCR-NW25 L85	(φ20)	φ40	85	12	40
HSV-TF2G 1/2VCR-NW25 L110	(φ20)	φ40	110	12	65
HSV-TF2G 1/2VCR-NW25 L170	(φ20)	φ40	169	12	123
HSV-TFLG 1/2VCR-NW40 L94	(φ30)	φ55	94	12	49
HSV-TFLG 1/2VCR-NW40 L201	(φ30)	φ55	201	12	156

※VCR® is a registered trademark of the Cajon Company.

Venting Time

HSV-TF3G 1/4"VCR

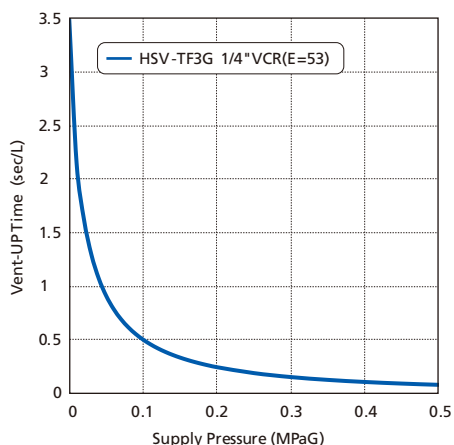

HSV-TF2G 1/2"VCR

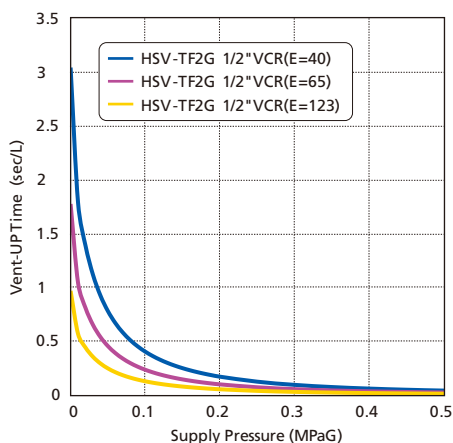

HSV-TFLG 1/2"VCR

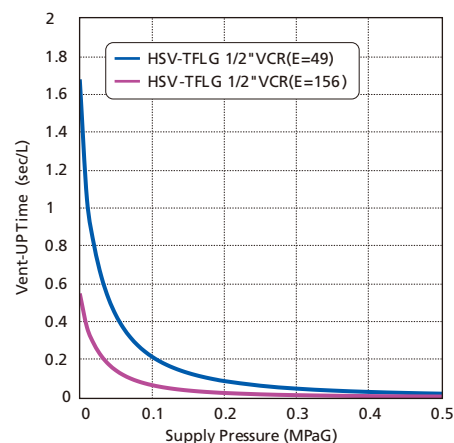

※The vent times vary as a function of gas supply pressure.

※The data listed in this catalog are representative figures provided under specific conditions.

Please confirm whether the specifications of the product apply to desired operating conditions.

※Nippon Seisen makes no guarantee regarding the applicability of its filters or fitness for particular applications.

The specifications of the product are subject to change without notice.

※Please contact Nippon Seisen with any questions.